

**FENCING
& BARBED
WIRE**



GRATINGS



**SOLAR
STRUCTURE**



**EARTHING
MATERIALS**



**STREET
LIGHT POLES**

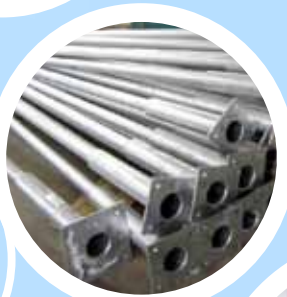

LT PANELS



CABLE TRAYS

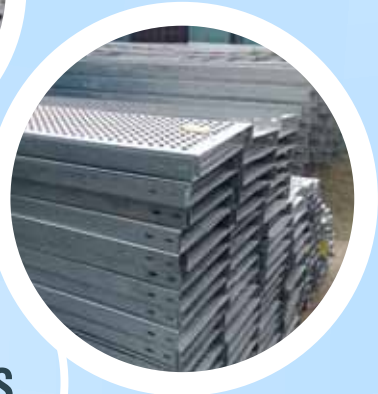

MNR Electricals

AN ISO 9001:2008 COMPANY

www.mnrelectricals.com

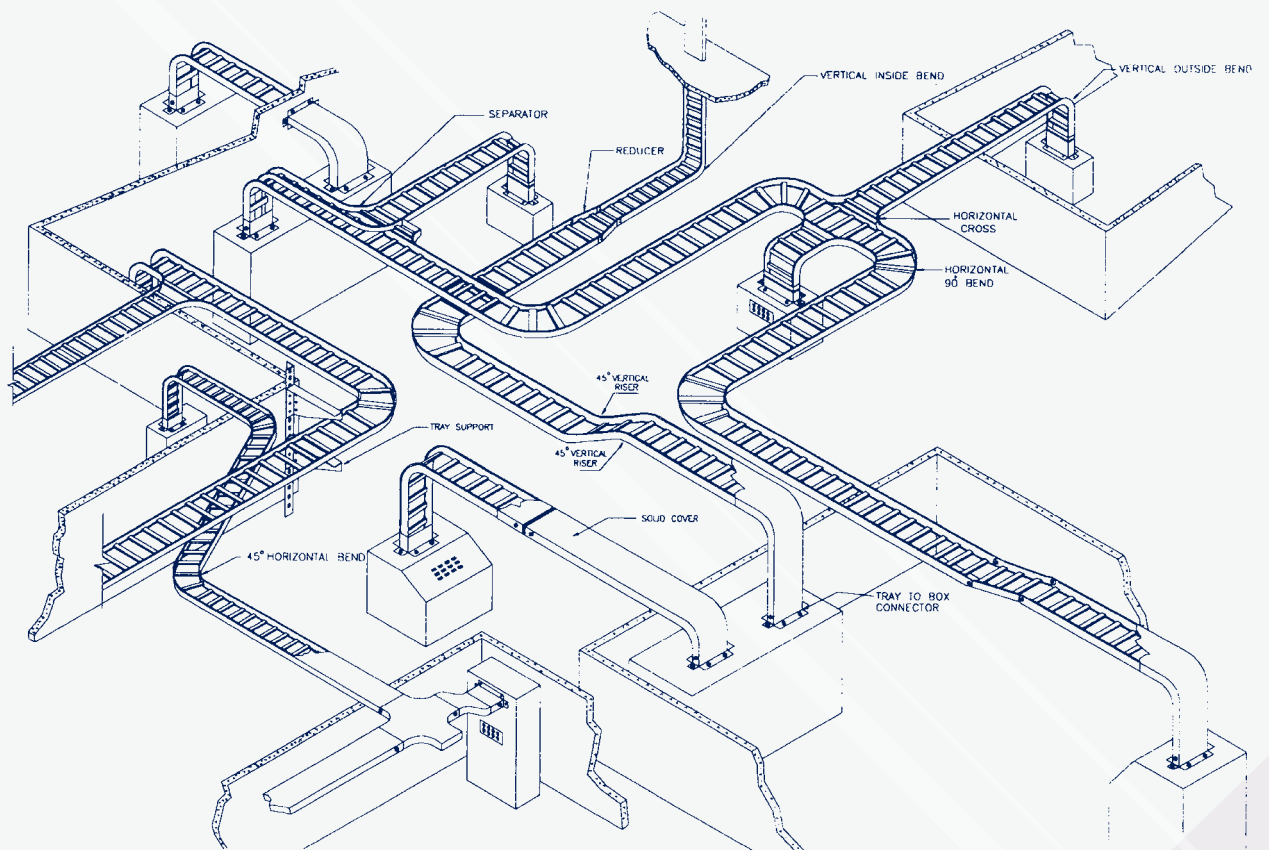

MNR ELECTRICALS is ISO 9001-2008 Certified company, Established in the year 2005. MNR is an esteemed manufacturer and supplier of a wide range of Electrical Products Like Cable Trays, ladder type cable tray, Perforated Cable, Raceways, Gratings, Earthing material and Street Light Poles. We also manufacturing of Low Voltage Control Panels like PCC, MCC, and APFC & Junction boxes. Our sheet metal cable trays and other Products are manufactured according to the Industrial standards. The direction of our experienced engineers ensures the smooth operation. High-grade, durability, strength, easy-furnishing are some of the specification of our products.

We manufacture a complete range of cable trays and industrial cable trays, which are innovative in design, easy to install and cost-effective in usage. As these trays come in powder coated finish, these are corrosion resistant and can be used in outdoor spaces. These trays are ideal to support large volume of network cables and also assist in providing smooth transition around obstacles.

We are supported by a team of highly qualified and experienced technicians who helps in executing a perfect product range that best fit to customers' expectations. Our qualified engineers are backbone of the company who enables us to accomplish the project perfectly and within the stipulated time frame matching to clients' specifications.

Why Us?

We have acquired a trustworthy position in this specified domain by offering an impeccable and innovative range of Electrical Sheet Metal Components. With the aid of our well-equipped production unit and reliable workforce, we have been successfully able to meet the bulk & urgent requirements of our patrons within the stipulated time frame.

Besides this, following are some of the essentials that have enabled us to maintain cordial business relationships with our patrons:

- Continues improvement of work process achieve maximum customer satisfaction
- Constant efforts to improve the functional efficiency of the products
- Capitalization on skilled & experienced workforce
- Pool of efficient engineers experienced with the latest technologies
- Empowered with strong market network
- Quick delivery and better reporting system to inform customer regularly to plan their imports
- Products offered at industry leading prices

Mission

We committed to providing the highest quality products, competitively priced, with services exceeding our customers expectations. We will continue to invest in facilities, systems and highly trained technical personnel providing added-value to our business relationships.



Vision

Electricals is a cornerstone of our quality of life. There will be a continuing need for products and services to harness its use. MNR Electricals will strive to be best-in-class as a distributor of quality products and services and a responsible corporate citizen.

Quality Policy

At MNR Electricals, we are committed to producing only the highest quality products that meet or exceed our customers' expectations and requirements. Our goal is to achieve 100% customer satisfaction, by delivering the best products and services, on-time and free of defect. We will achieve this individually and corporately through tested and proven process and controls in our Quality System, with a constant focus and effort on continuous improvement.

Product Portfolio

We are an eminent organization of this domain, engaged in manufacturing and trading a commendable array of Electrical Sheet Metal Components. Offered range of metal components are designed and developed under the astute guidance of our team of assiduous professionals, who leave no stone unturned to attain maximum level of client satisfaction. The complete range that we offer can be availed by us in various sizes, grades and dimensions along with suitable customized options. Furthermore, these metal products find extensive application in textile, automobile, foundries, construction, electrical, engineering and other allied industries.

Products that our range comprises

- Cable trays (Perforated, Ladder Type & Angular)
- Electrical raceways (Cable Ducts & trunkings)
- Cable Tray Covers, Coupler Plates and Hardware
- Cable Tray Accessories (Junction boxes, Bends, Cross, Tee, Elbow & Reducers)
- Cable Tray Supporting systems (Channel Rails, U Bolts, Clamps, Brackets, GI Threaded Rod and Fastener)
- Earthing material (GI Flat & Wire, Copper Flat & Wire, Aluminum Flat, Earth electrodes & Pipes and etc.)
- Gratings (Flat Floor Gratings)
- Chain Link & Fence (Barbed wire & Pipes)
- Solar Structures (C Channel or Z Channel)
- Street Light Poles (Swaged & Designed street light poles)
- Low Voltage Panels (PCC, MCC, APFC, Kiosk, LDB, PDB & Bus ducts)

Some features are:

- Robust construction
- Resistance to corrosion
- Optimum performance
- Low maintenance
- High tensile strength
- Longer functional life
- Perfect finishing
- Capability to withstand extreme temperature conditions

Standard Cable Trays & Accessories

Technical Specification

MATERIAL	FINISH	STANDARD
Mild Steel	Bare Finish	IS1079/IS2062
	Hot Dip Galvanized after fabrication	IS2629/4759, BS729, ASTM123
	Electro Galvanized after Fabrication	IS12753
	Red Oxide Painted	IS2075
	Epoxy Painted	IS7348
	Synthetic Enamel Painted	IS101-1988
	Powder Coated after Fabrication	IS7651
GI Sheet	Pre-galvanized	IS277
Aluminium	Bare-Finish	IS8011/IS1060
Stainless Steel	Bare-Finish	SS304/SS316
Customer Specified	---	--

Strength	Thickness (T)	Tray Width (W)	Tray Height (H)	Tray Collar (C)	Tray Length (L)	Bends	
						Radius	Degrees
Light Duty	1.2mm (18swg) 1.6mm (16swg)	50 mm To 1000/ 1200mm	20 mm / 25 mm / 40 mm / 50 mm / 75 mm / 100 mm / 125 mm	10 mm or 15mm or 25mm	2500mm or 3000mm	300mm or 450mm or 600mm or 1000mm	30mm or 45mm or 60mm or 90mm
Medium Duty	2.0mm (14swg)						
Heavy Duty	2.5mm (12swg) 3.0mm (10swg)						

Cable Tray Selection - Material & Finish

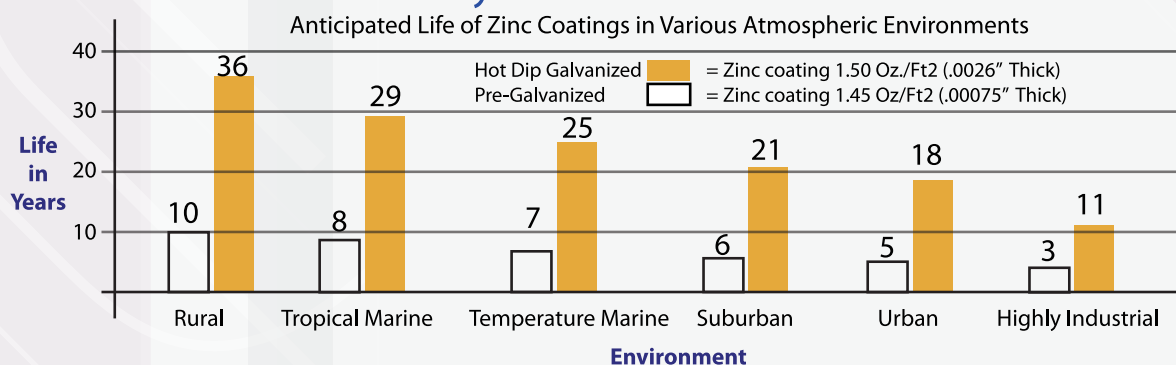

Standard Cable Tray

Perforated Type



We bring forth an impeccable array of Perforated Cable Tray for our clients. Offered trays are widely used for installation of regular cables as well as controlled cables in various industries and sectors. Our range is widely acclaimed for its ability to accommodate a large number of branch lines giving a high load bearing capacity. Furthermore, we also offer these cable trays in various customized specifications as per the requirement of our clients.

Double Bend Perforated Tray

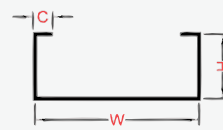
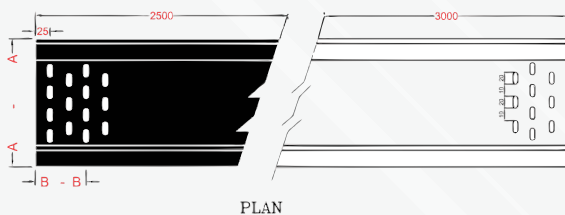

Section A - A

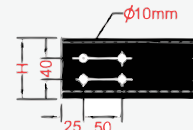

Section B - B

Single Bend Perforated Tray

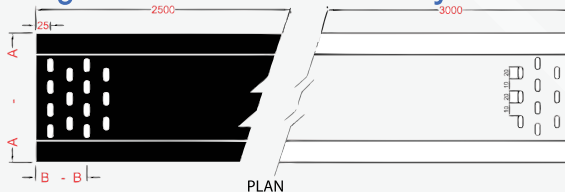

Section A - A

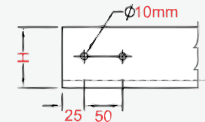

Section B - B

Perforation Details	Tray Width(w)	Tray Height(H)	Tray Collar (C)	Tray Length(L)	Thickness (T)	Types of Raw Material	Finish
Slot Size 20 x 10mm.	500mm to	20mm to	15mm to	2500mm to	1.6mm to	Mild stool(MS) or Aluminum(Al) or Stainless steel (S.S)	Hot dip Galvanized
Width wise: 10min gap. Length wise: 20.30& 40mm c/c gap	100mm	100mm	25mm	3000mm	3.0mm		Galvanized sheet (GI) Power Coated Enamel Painted

Perforated Tray Accessories

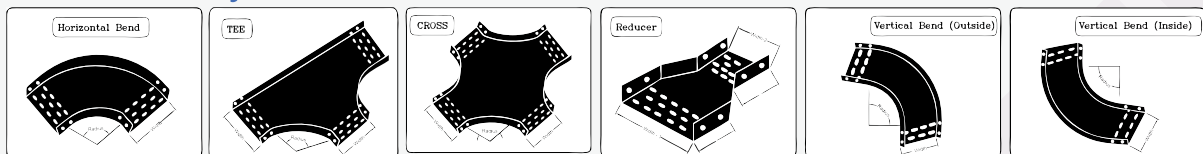

Radius	Types of Bends	Degrees
300/450/600/1000 mm or as per the choice customers	Horizontal, Vertical (Inside/Outside) Tees (Equal & Un-equal), Cross Reducers	30, 45, 60, 90 for Bends



Standard Cable Tray

Ladder Type

Ladder Type Cable Tray (LTCT)

Backed by an innovative setup, we bring forth a wide collection of Ladder Cable Tray to our valued clients. Our offered range of tray is widely acknowledged for its corrosion resistance that helps in efficient transmits of the product. These trays are designed and developed by making use of qualitative raw material that are sourced from the most renowned vendors of the industry. Customers can avail these in various sizes and grades as per their detailed specifications.

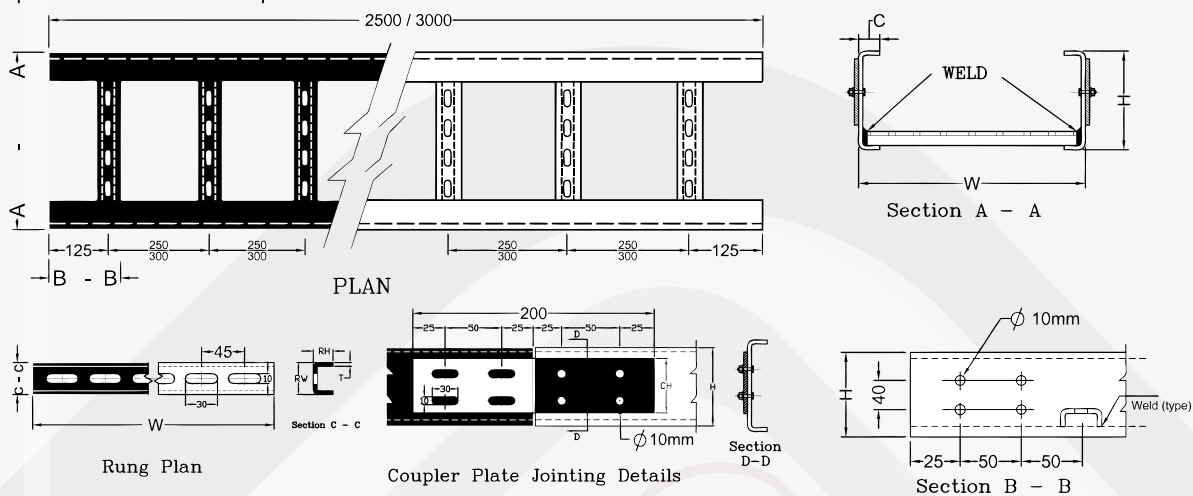

Tray Width (W)	Runner Height (H)	Runner Collar (C)	Rung Size	Rungs Interval	Rung Slot Size	Thickness (T)	Tray Length(T)	Finish
100mm	50 mm	15 mm	35 x 15 mm	250 mm or 275mm	20x10 mm Width Spacint 10mm /15 gap	1.6mm to 3.0 mm	250mm or 3000mm	Hot Dip Galvanized or powder Coated Enamet Painted

Ladder Tray Accessories

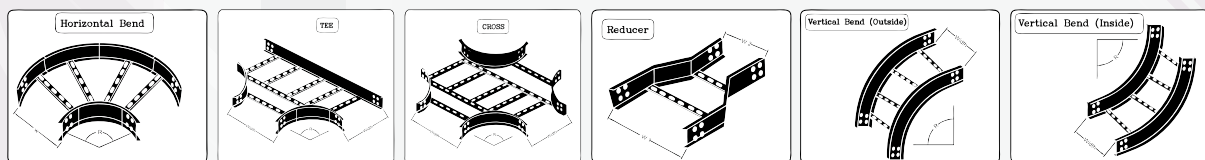

Radius	Types of Bends	Degrees
300/450/600/1000 mm or as per the choice customers	Horizontal, Vertical (Inside/Outside) Tees (Equal & Un-equal), Cross Reducers	30, 45, 60, 90 for Bends

Standard Cable Tray

Angular Ladder Type (ALTCT)



MNR Angular Ladder Type(ALTCT) are fabricated to M.S.Angles Confirming to I.S. 2062;1992.

M.S. Angles are used as Runners and M.S. Flats as Rungs. Rung spacing is 250mm length and 300mm for 3000mm length of Cable Trays. Rungs can be provided Single/Double, as per the Customer's choice

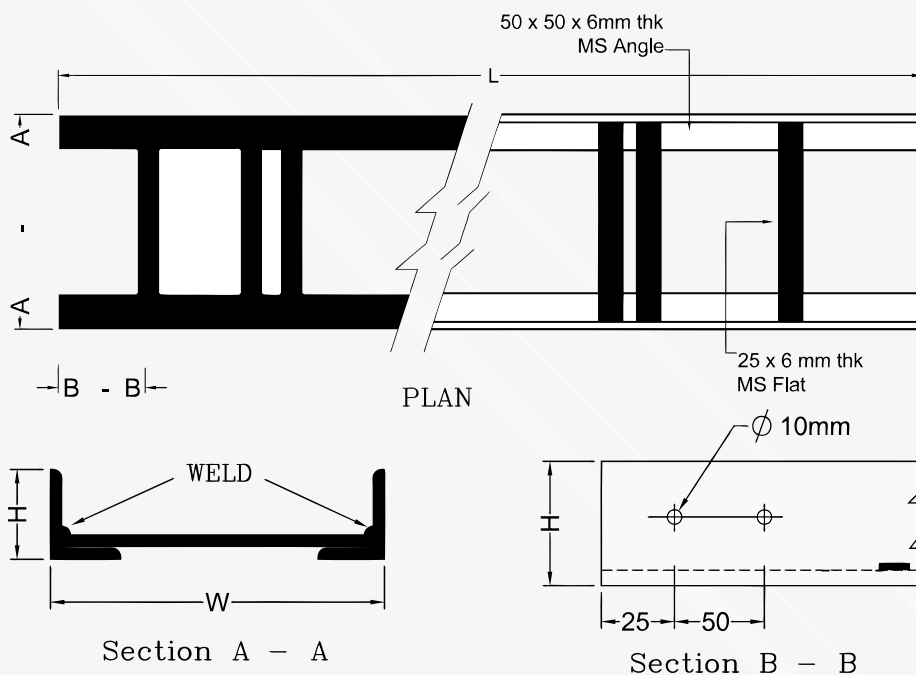

Tray Width (W)	Runner Angle	Rung (Flat)	Rungs Spacing	Tray Length (L)	Finish
150 mm or 1000 mm	25x25x6 mm 40x40x6 mm 50x50x6 mm 65x65x6 mm 75x75x6 mm	25x3 mm 25x6 mm 32x6 mm 50x6 mm	250 mm or 300 mm Interval Double & Single Rungs	2500 mm or 3000 mm	Hot Dip Galvanized Powder Coated

Angular Ladder Type Accessories

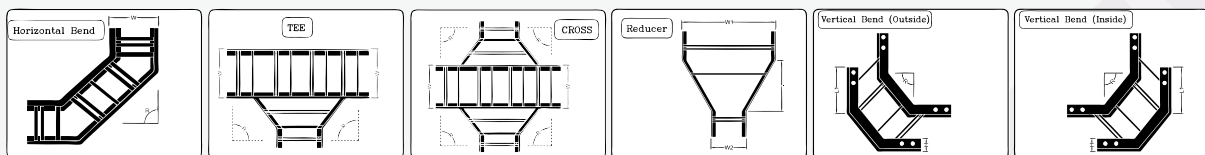

Radius	Types of Bends	Degrees
300/450/600/1000 mm or as per the choice customers	Horizontal, Vertical (Inside/Outside) Tees (Equal & Un-equal), Cross Reducers	30, 45, 60, 90 for Bends



Standard Cable Tray

Race way / Cable Duct

Straight sections of solid bottom cable trays constructed from single sheet of metal, providing excellent protection from external damage. They are used primarily for instrumental control, communication and other non-heat producing cables.

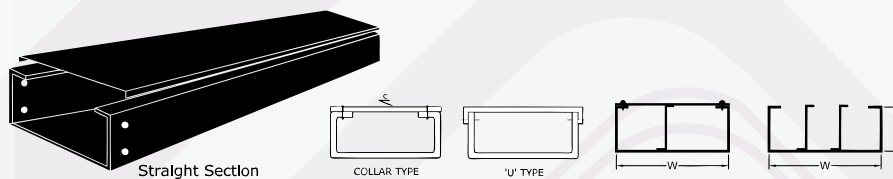
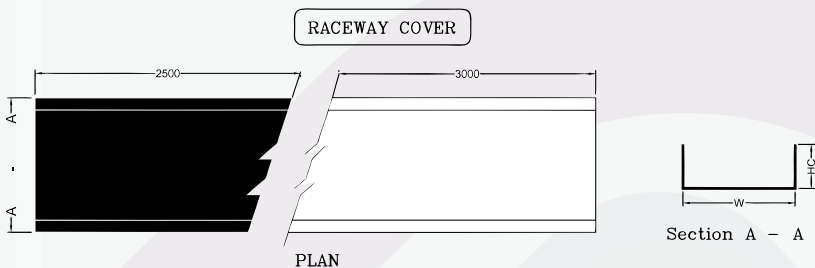
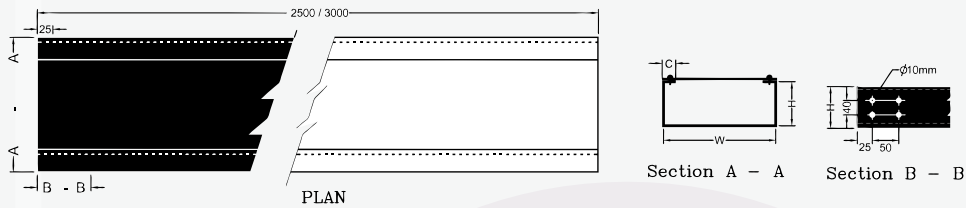

Tray Width (W)	Runner Height (H)	Runner Collar (C)	Thickness (T)	Tray of Raw Material	Finish
50mm or 600 mm	25 mm to 100 mm	15 mm to 25 mm	1.6 mm to 3.00 mm	Mild Steel (M.S) & Aluminium & S.S	Hot Dip Galvanized Powder Coated Enamel Painted

Accessories

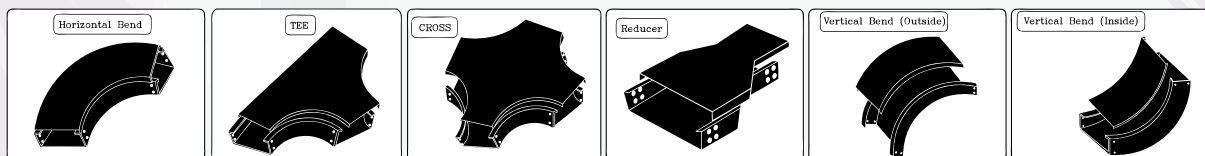

Radius	Types of Bends	Degrees
300/450/600/1000 mm or as per the choice customers	Horizontal, Vertical (Inside/Outside) Tees (Equal & Un-equal), Cross Reducers	30, 45, 60, 90 for Bends

Standard Cable Tray Covers

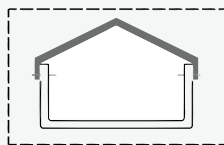
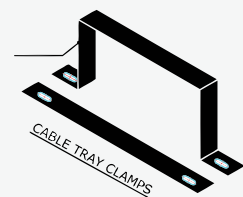
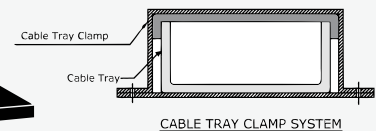
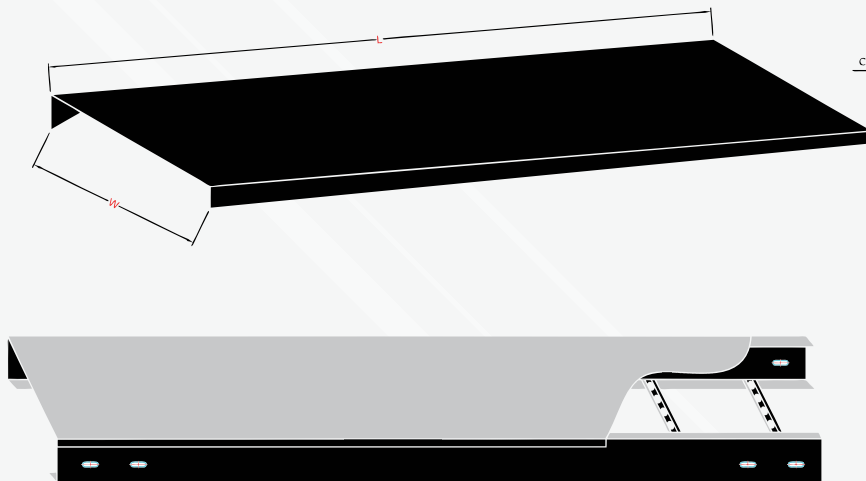

Hut Type (Dome)

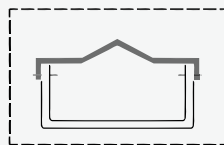

Flat & Hut Type (Dome)

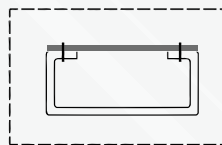

Flat Cover

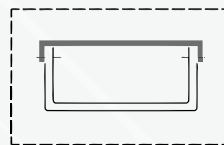

U Type Cover

Tray Width (W)	Cover Collar (Q)	Thickness (T)	Tray of Raw Material	Cover Length (L)	Finish
50mm or 1000 mm	15 mm to 25 mm	1.6 mm to 3.0 mm	Mild Steel & Aluminium	2500 mm or 3000 mm	Hot Dip Galvanized Galvanized Sheet (GI) Powder Coated Enamel Painted

Accessories

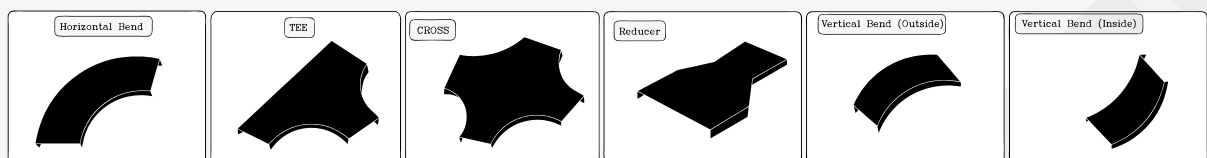

Radius	Types of Bends	Degrees
300/450/600/1000 mm or as per the choice customers	Horizontal, Vertical (Inside/Outside) Tees (Equal & Un-equal), Cross Reducers	30, 45, 60, 90 for Bends

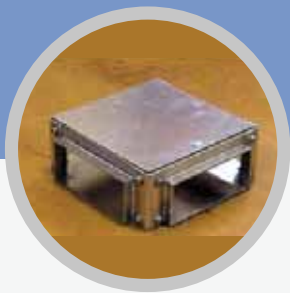

Standard Cable Tray

Couplers & Accessories

Application of Coupler Plates: As the standard length of cable trays are 2500mm/3000mm to join every two cable trays coupler plates are used. The thickness of coupler plates will vary 2mm to 3mm depending on customer requirement & design.

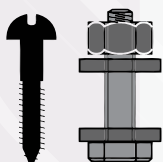
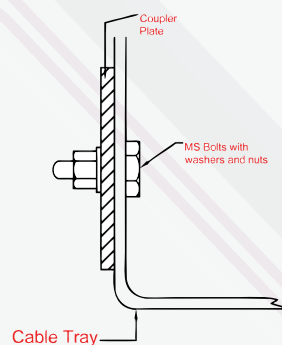
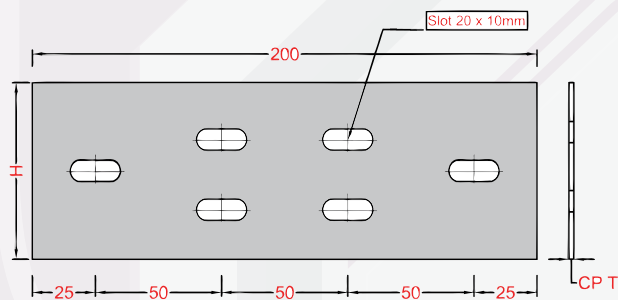
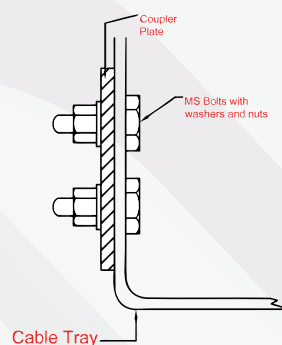
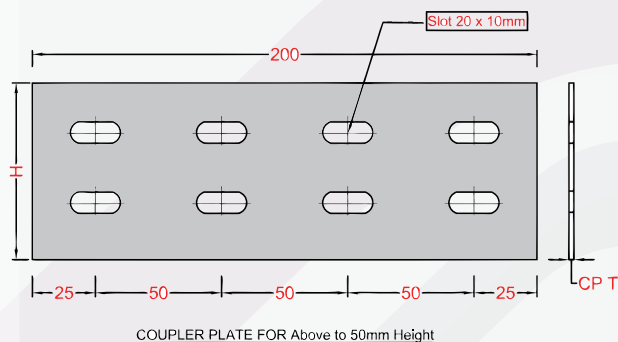
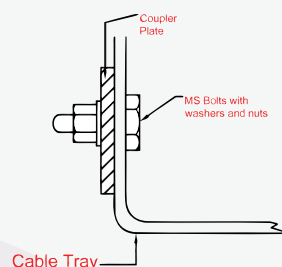
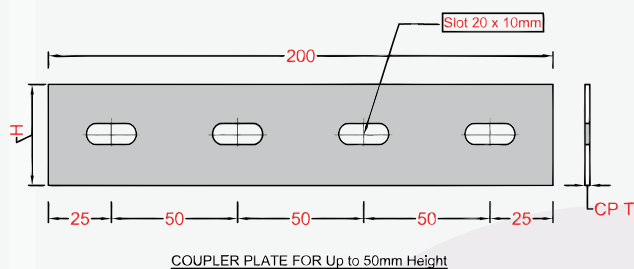

HARDWARE

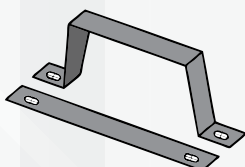

CABLE TRAY CLAMPS

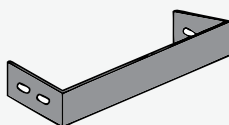

BLIND CLAMPS

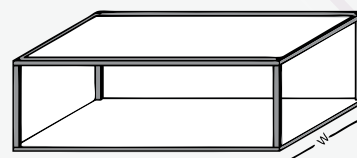

JUNCTION BOX

Size of Junction Box	Thickness	Type	Finish
300/450/600/1000 mm or as per the choice customers	1.6 mm to 3 mm	4 way & 2 way	Galvanized Sheet (G) Powder Coated Enamel Painted

Standard Cable Tray

Supporting System - Wall Mounted Type

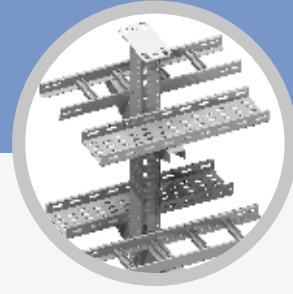

SINGLE RACK

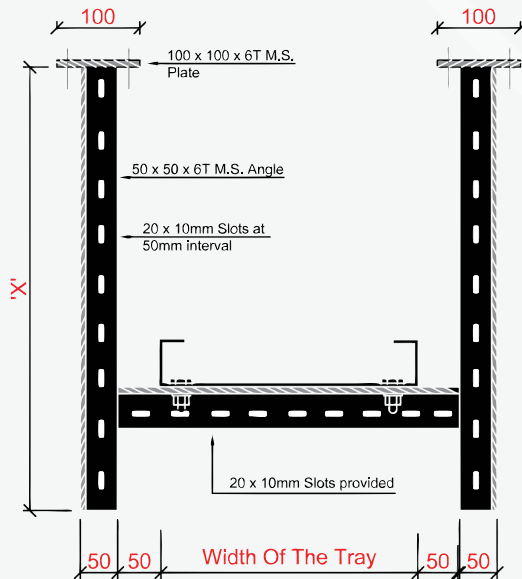
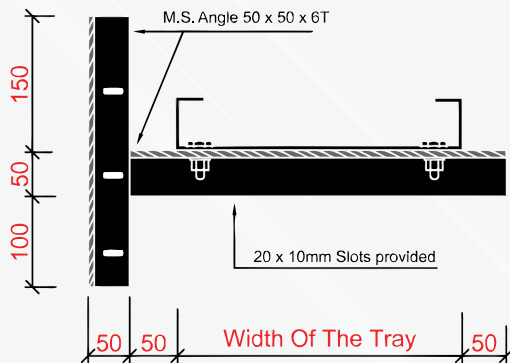

DOUBLE RACK

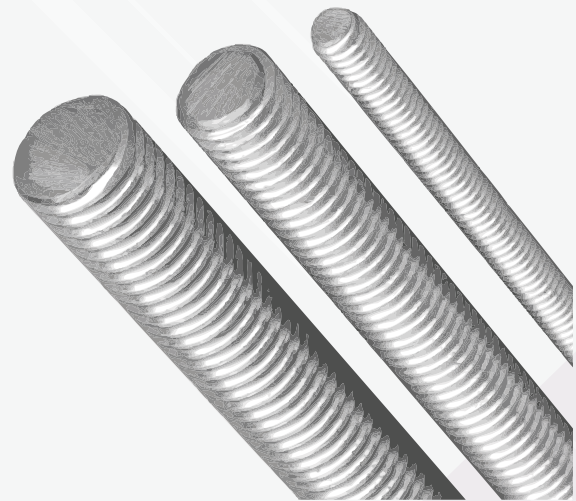
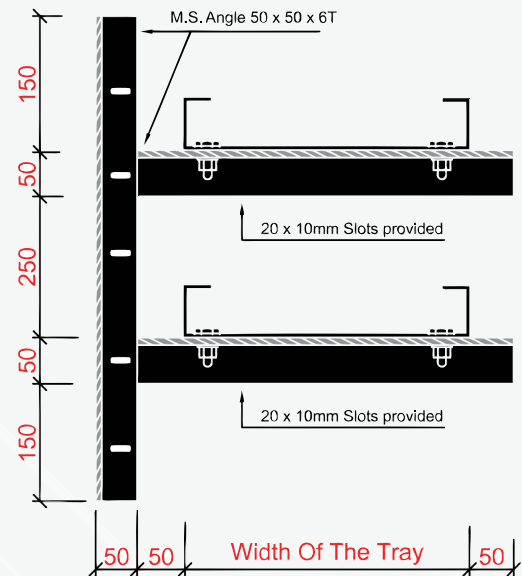

Note : 'X' Please specify

Type	Tier	Vertical Support	Horizontal (Cantilever Support)	Finish	Accessories	Welding	Slots
Single Double Channel & Angle	Available in 1-Tier 2-Tier 3-Tier 6-Tier	Angles(SA) 50x50x6 65x65x6 or ISMC-100	Angles(ISA) 50x50x6 65x65x6 or ISMC-100	Hot Dip Galvanized or painted	Rawal Plug or Exp'n Bolt for Grouting	ARC Welding by Central Govt. Qualified Welders	20x10 mm as per customers choice

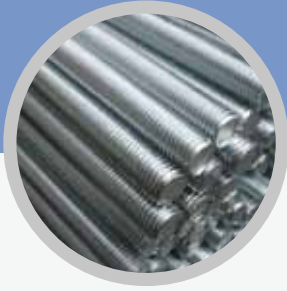

Standard Cable Tray

Supporting System Ceiling Mounted

Ceiling Mounted Support

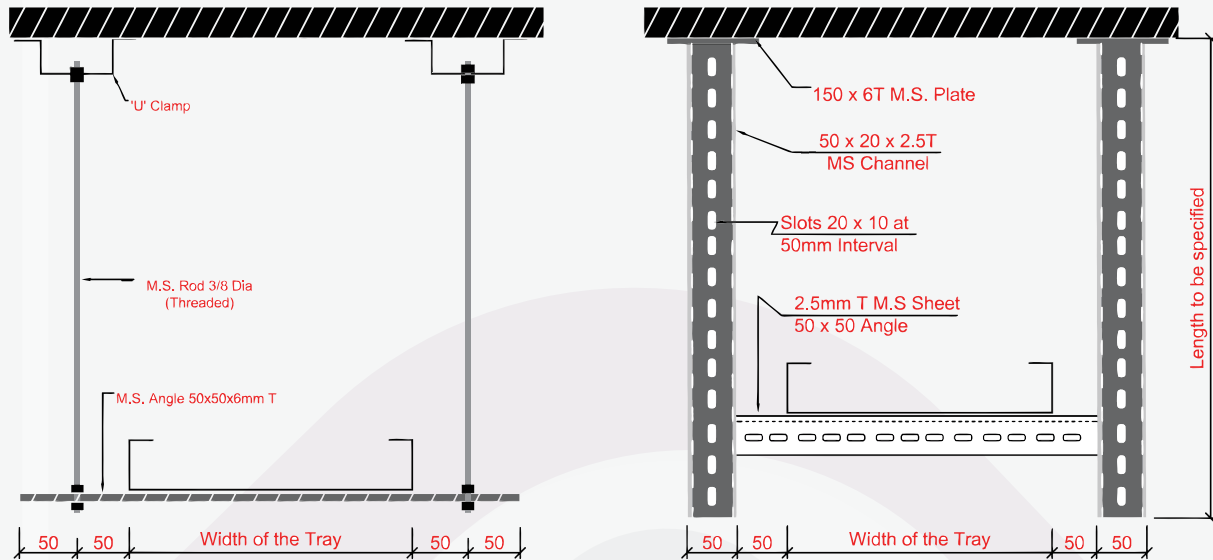

1. 'U' Clamp : 2 Nos of 'U' Clamp Fabricated out of 50x6mm M.S Flat (40x55x65x55x40)	1. 'Plate' : 150x150x6mm T M.S Plate
2. M.S.Road : 2Nos of 1000mm Length - 3/8 Dia threaded M.S Rod duly Electro Plated each will have 4Nos of Washers & Nuts for assembly.	2. 'C' Type Channel : 50mm x 20mm x 2.5mm T
3. M.S.Angle : M.S Angle 50x50x6mm duly slotted & drilled to take width of tray	3. Angle : 2.5mm T M.S. Sheet size 50x50mm

Note

1. All Dimentions are in mm & Its Tolerance will be Respective to Length, Width etc. Accordingly.
2. Tolerances On Length +/- 5mm & Rest all Dimensions +/- 2mm.
3. Finish : Hot dip / Electro Galvanized / Painted / Bare Finish.
4. Anchor Bolts / Tray Fixing Hardware's are not Included in Our Scope of Supply
5. This Dramwina is not scale

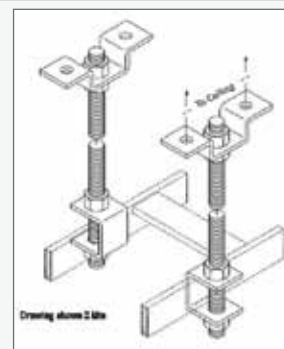

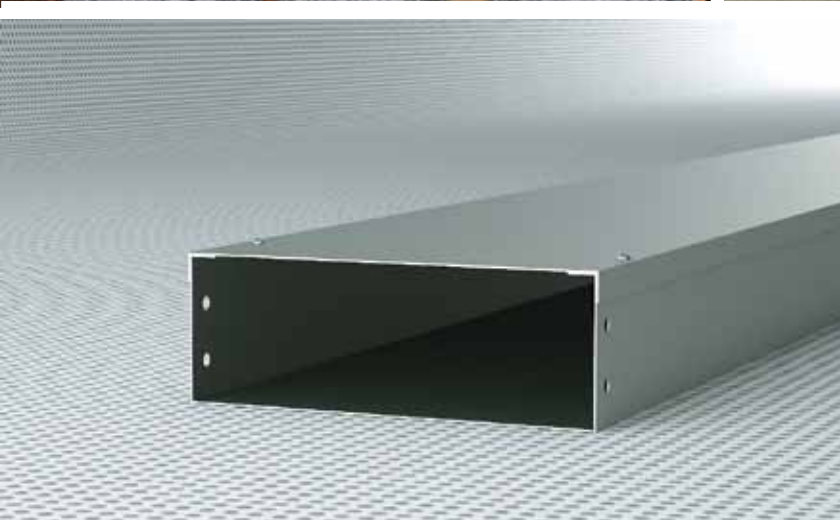

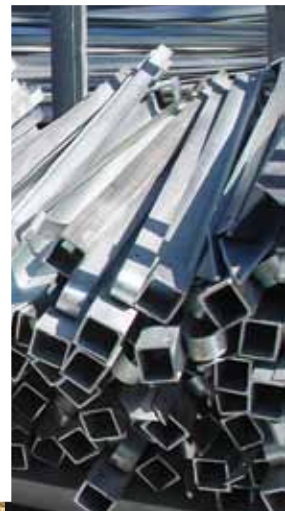
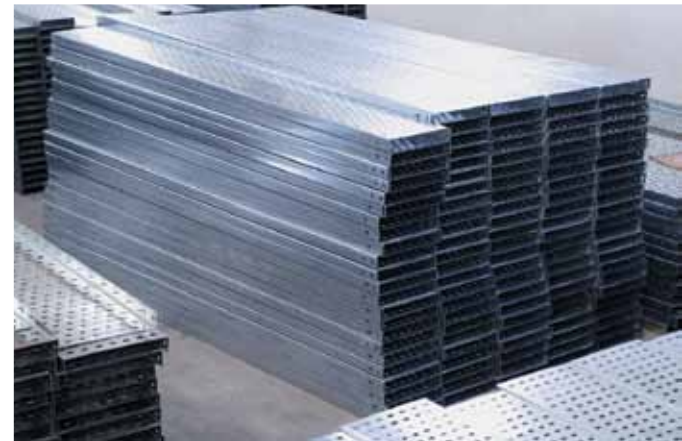
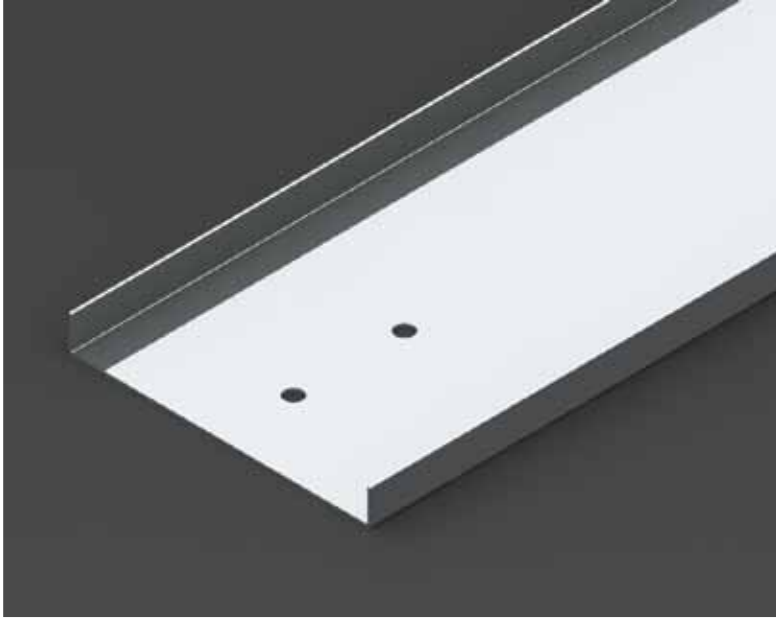

Standard Earthing Materials

GI, Aluminium, Copper Flat and Wire

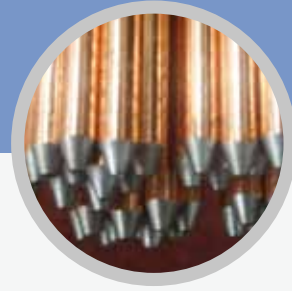

GI FLAT



COPPER FLAT



COPPER WIRE

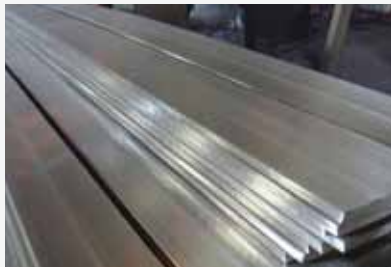

ALLUMINIUM FLAT



GI WIRE



GI/EARTHING PIPES

G.I. Strips & Plates

These are used as earthing material along the length of cable trays & electrodes.

These strips are available in different widths and thickness confirming to I.S.2062; 1992

Aluminium Strips

These are used for binding the Cable Trays

GI Wire

These are used for binding the Cable Trays and available in various Gauges.

Stainless steel (SS) Bolts & Nuts & Washers Earthing Rods in M.S. Galvanized up to 40mm Dia ISMC CHANNEL & Angles.

Any other size of your choice can be supplied on order.

Note: Hot Dip Galvanized after fabrication
I.S. 3043 : 1987

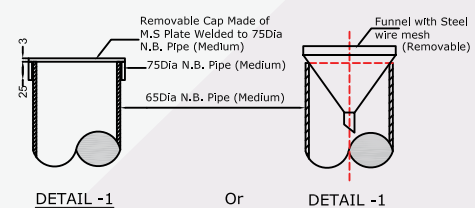
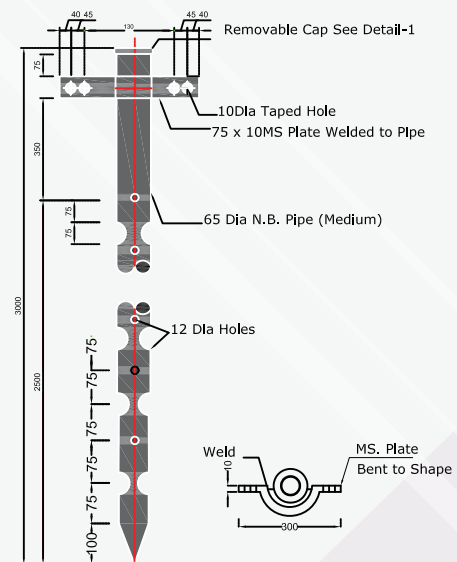

EARTH ELECTRODE



Standard Earthing Earthelectrodes & Compound

Advanced Earthing Electrodes

MNR advanced earthing electrodes are engineered to endure the most enviously corrosive environments. These electrodes are robust enough to withstand fault currents of very high magnitude. Fabricated from excellent quality G.I./Copper pipes, these electrodes are virtually indestructible.

The pipes are profiled with propriotor super conductive crystal-line compound' which encloses the primary conductor completely, increasing it's surface are and also forming a protective layer against corrosion. It never allows the primary conductor to come in direct contact with corrosive elements in the surrounding soil.

Features:

1. Robust design to last for a lifetime
2. Three level protection from corrosion
 - a) Outer Pipe (GI/Copper)
 - b) Layer of super conductive crystalline compound
 - c) Primary conductor (Pipe / Strip)



GI Electrodes

MODEL	LENGTH (MM)	PIPE DIA (MM)	PRIMARY CONDUCTOR	PRIMARY CONDUCTOR SIZE
MNR-150G	1000	50	Strip	40x6x1000MM
MNR-250G	2000	50	Strip	40x6x2000MM
MNR-280G	2000	80	Strip	50x6x2000MM
MNR-350G	3000	50	Strip	40x6x3000MM
MNR-380G	3000	80	Strip	50x6x3000MM

GI Electrodes

MODEL	LENGTH (MM)	OUTER PIPE DIA (MM)	INNER PIPE DIA (MM)	STRIP SIZE
MNR-250PIP	2000	50	40	30x6MM
MNR-280PIP	2000	80	50	40x6MM
MNR-350PIP	3000	50	40	30x6MM
MNR-380PIP	3000	80	50	40x6MM

Note: Electrodes can also be manufactured as per clients' given specifications.

Gratings

Expanded Floor Gratings

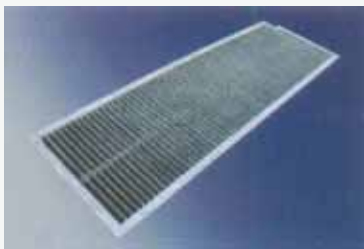
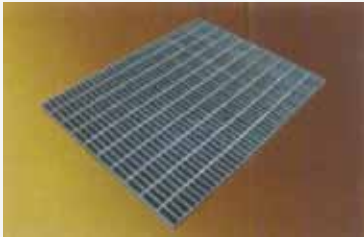
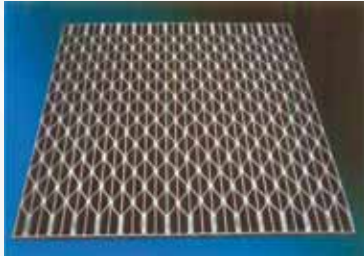

What is Grating?

An open grid assembly of metal bars, in which the bearing bars, running in one direction, are spaced by rigid attachment to cross bars running perpendicular to them or by bent connection bars extending between them.

Bearing Bars - Load carrying bar made from steel strip, or slit sheet or from rolled or extruded aluminium and extending in the direction of the grating span.

Cross Bars - The connecting bars, made from steel strip, slit sheet or rolled bars, or from rolled or extruded aluminium, which extend across the bearing bars, usually perpendicular to them. They may be bent into a corrugated or sinuous pattern, where they interact the bearing bars which are welded to them.

BEARING BARS	CROSS BARS	TYPE OF RAW MATERIAL	SIZES	FINISH
25 x 6 mm 32 x 5 mm 32 x 6 mm 40 x 6 mm 50 x 6 mm etc.,	10 mm Sq 12mm Sq. 25mmx6mm 32 x 5 mm 32 x 6mm 40 x 6mm 50 x 6mm etc.,	Mild Steel & Aluminium	As per the customer requirement	Hot Dip Galvanized Power Coated Enamel Painted

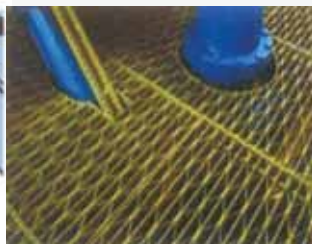
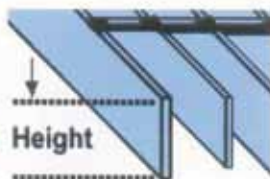
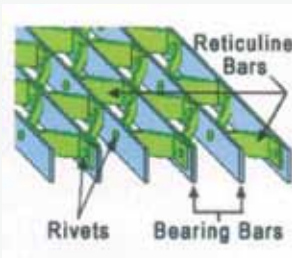



Other Products

Chain Link & Fence



Chain link sizes available:

12gauge or 2.5mm:1.25",1.5",2",2.5"
10gauge or 3mm:2",2.5",3",3.5",4"
8gauge or 4mm:2",2.5",3",3.5",4"

Chain link wires available:

Galvanized and PVC coated

Posts available:

Angle and pole

Our products and services:

1. Chain link
2. Fencing posts
3. Turnkey projects

Accessories:

Strut posts
Strainers
Tensioners
High tension wire
Twist ties and tool
Barbed wire

Advantages of chain link:

1. Beautiful
2. Economic
3. Better air flow
4. Faster installation
5. Height not a factor
6. Encroachment proof
7. Weather proof

Standard Light Poles

Swaged Poles



MNR is a recognized, top-of-the line Black pipe manufacturer, which ensures best quality raw materials for pole manufacturing, in house. MNR poles are available in galvanised and painted forms in all lengths, satisfying customer's requirements. MNR Brand of poles therefore enjoy a leadership position in the market place, and are trusted widely for product quality, infrastructural capability, technology process eligibility and resourcefulness.



Outside Diameter of smaller Tube in Joint mm	Length of Joint (J1 or J2) mm
76.1	200
88.9	230
114.3	300
139.7	350
165.1	400
193.7	450



TOLERANCE OF STEEL TUBULAR POLES

Outside Diameter (±) :	1%
Thickness (-) :	10%
Section Length (±) :	40 mm
Overall Length (±) :	25 mm

Weight

Bulk (-) :	7.5%
Single (-) :	10%
Straightness :	1/600

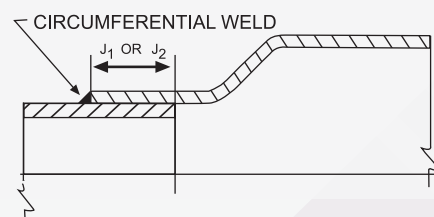
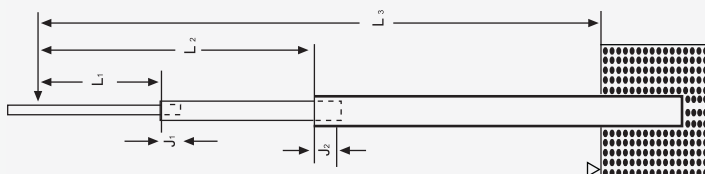

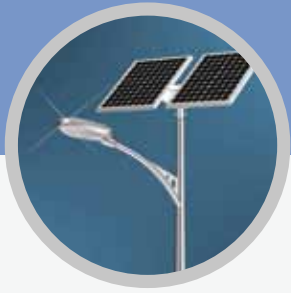

Standard Light Poles

Designed / Customized Poles

Designer / Customised Poles

To meet the challenges of architects, planners & end-users; we design our poles and the brackets with plate and square/circular pipes. We have developed various aesthetically designed steel poles to suit all the purposes.

Apart from the designs in this catalogue you are welcome to send in your designs for customisation to meet your specific need.

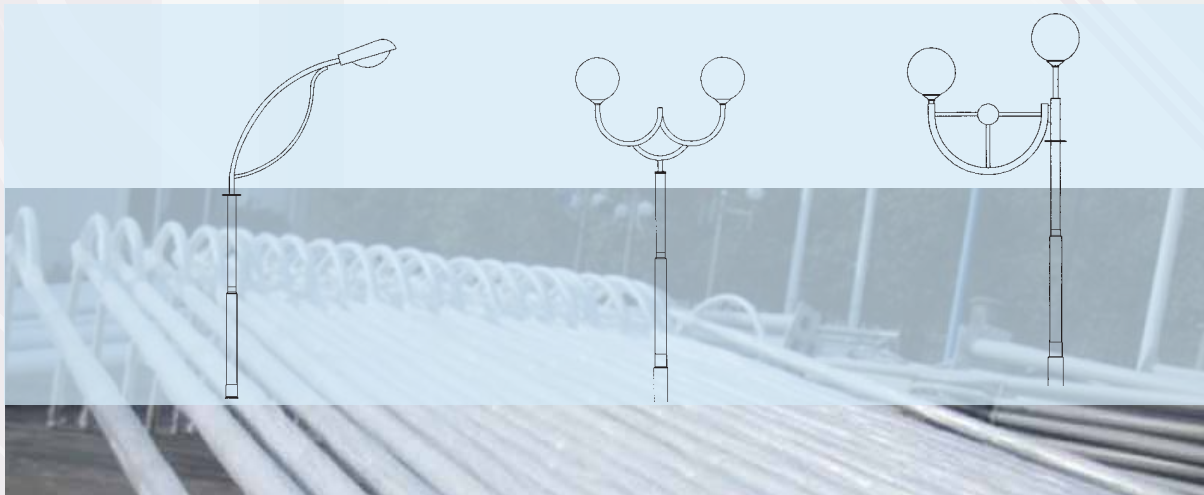
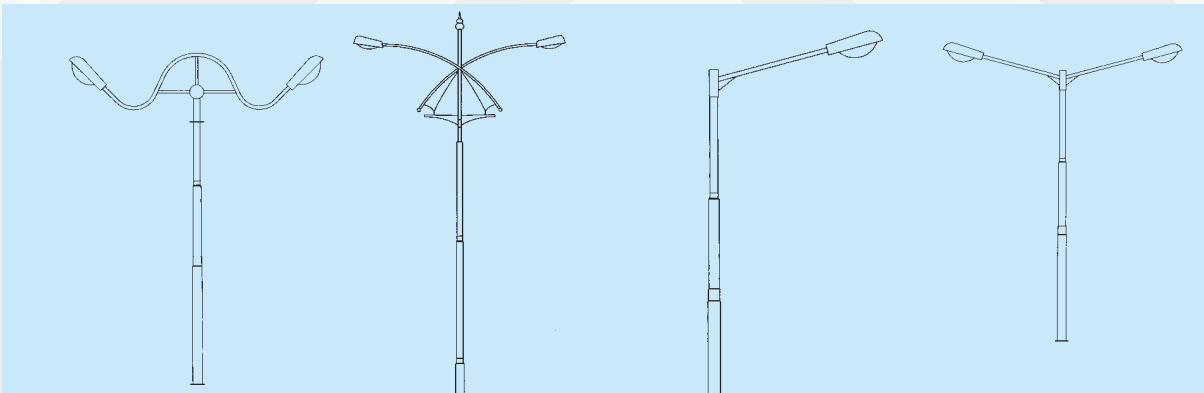
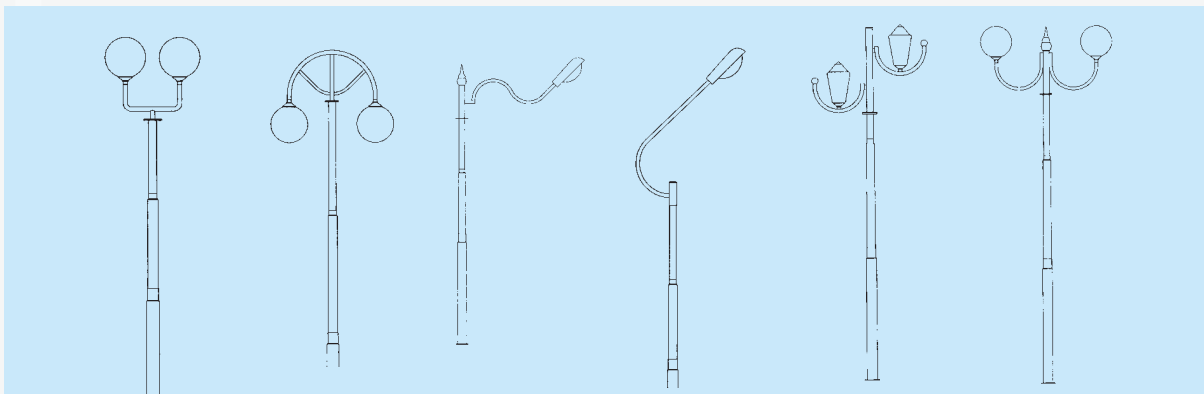

Solar Structures

Solar Module Mounting Systems

we are one of the largest manufacturer of solar module mounting systems in India. We offer a wide range of mounting solutions for all types of solar projects. Our in-house production, quality control and continual product development guarantees excellence of our entire product range.

Mounting Structures - Types of Sections:

- C-CHANNEL
- C-CHANNEL with Lip
- Strut Rail
- Z Channel
- Z Channel with Lip
- Sigma Section
- L Angle
- Hat Section
- Hot Rolled Section

Main Products

1. Ground based module mounting structures
2. Roof mounted structures
3. Module mounting clamps
4. Concentrated solar power support structure
5. Pre fabricated inverter rooms and control rooms
6. Solar powered telecom towers



ELECTRICAL PANELS

Low Voltage (LT)

Motor Control Center (MCC) Panels

Power Control Center Panels (PCC)

Automatic Power Factor Control Panels

AC/DC Drive Panels (VFD, SOFT Starter)

LT Distribution Panel Boards

MCB Distribution Boards

Fuse Distribution Boards

A.M.F. (Auto Mains Failure) Panels

DG Auto / Manual Load Sharing Panels

Control & Relay Panels, Control Desks

Auto Transformer Starter Panels (ATS)

Medium Voltage Segregated Bus Ducts

Non Segregated Bus Ducts

High Voltage 11/33kv Bus Ducts

Panels Erection & Commissioning

GI, MS Cable Trays, Cable Ducts (all Sizes and all types)

Outdoor LT Kiosks

Change Over Panel Boards

D.G. Set Control Panels

Lighting Control Panels

Bus Coupler Panels

Synchronizing Panels

Metering Panel Boards

Junction Boxes, Feeder Pillars

Residential Distribution Boxes

PLC Panels



Engineering Data

MNR Cable Trays and Accessories shall confirm current applicable standards as listed below

Coating Thickness of Final Finish

Epoxy Coated

: 50Microns

Powder Coated

: 50 Microns (Colors available, Elegant to look at and good for indoor usage.)

Hot Dip Galvanizing

: As per I.S. 4759 and I.S.2629
(Very useful for all out door and indoor uses and for Coastal areas)

Enamel Painted

: All Colors

APPLICABLE INDIAN STANDARDS (I.S.)

Hot Rolled Low Carbon Steel Sheets and Strips

: As per I.S.. 1079 : 1994

Cold Rolled Low Carbon Steel Sheets & Strips
Specification

: As per I.S. 513:1994

Steel for General Structural Purposes Specification

: As per I.S. 2062:1992

Specification for Rolling & Cutting

Tolerances for Hot Rolled Steel Products

: As per I.S. 1852 : 1985

Code of Practice for use of Metal

Arc welding for general construction in Mild steel

: As per I.S. 816:1969

Specification for Zinc

: As per I.s. 209:1979

Code of practice for Earthing

: As per I.S. 3043:1987

Specification for Plain Washers

: As per I.S. 2016:2001

Specification of Synthetic enamel paint
exterior under-coating and finishing

: as per I.S. 4759:2001

Code of practice for Training and Testing of
Metal Arc Welders

: As per I.S. 817:1997

Hexagon bolts, screws and nuts of product grade 'C'

: as per I.S. 1363:2002

Recommended practice for Hot Dip Galvanizing

: As per I.S. 2629:2001

INSPECTION TEST:

Specification for Hot Rolled Carbon Steel Sheet and Strip

: As per I.S. 1079 : 1994

Cold Rolled Low Carbon Steel Sheet & Strips Specification

: As per I.S. 513:1994

Deflection Test (for Max. Permissible deflection limit)

: As per Customer / consultant specification

DIMENSIONAL TEST & VISUAL CHECKS

Specification for Hot Dip Zinc coating on Structural Steel
and other allied products

: As per I.S. 4759:2001

Methods for Testing uniformity of coating of Zinc
coated articles

: As per I.S. 2633 :2001

Adhesion Test

: As per I.S. 2629 : 1985

Method of determination of mass of Zinc coating on zinc
coated iron & steel articles

: As per I.S. 6745 : 1998

Zinc Coating Thickness

: by Elco Meter (for quick reference, as per is 4759)

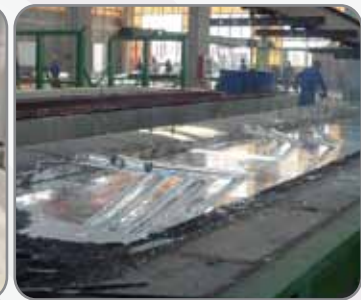

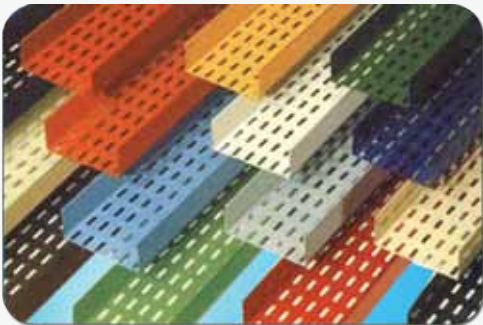

Client List





Corporate Office: #5-35/162, Sy.No.404, Sony Complex, 2nd Floor
Prashanti Nagar, I.E. Kukatpally, Hyderabad-500 072

Factory: 5-9-285/10, Rajiv Gandhi Nagar, I.E., Prashanti Nagar,
Kukatpally, Hyderabad-500 072. Telangana, INDIA.

Tel: 040-23720059 / 60, 99899 90862, 98496 89662

Email: mnrelectricals.999@gmail.com, mnr@mnrelectricals.com

Web: www.mnrelectricals.com, www.mnrelectricals.net